



Yuasa Technical Data Sheet

Yuasa 6N11A-4 - Conventional 6 Volt Battery

Performance

Voltage	6
Capacity (10-hour)	11Ah
Capacity (20-hour)	11.6Ah

Dimensions ($\pm 2\text{mm}$)

Length	122mm
Width	62mm
Height	131mm

Weights & Measures

Mean Weight with Acid	2.1kg
Acid Volume	0.4l

Technology

Technology	Cast Sb/Sb
Separator	Reinforcing fiber+Glass Fiber



Cell Assembly Layout



Terminal Type - 6

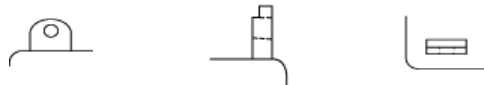

Data Sheet generated on 05/02/2023 - E&OE