



## Yuasa Technical Data Sheet

### Yuasa B49-6 - Conventional 6 Volt Battery

#### Performance

|                    |       |
|--------------------|-------|
| Voltage            | 6     |
| Capacity (10-hour) | 8Ah   |
| Capacity (20-hour) | 8.4Ah |

#### Dimensions ( $\pm 2\text{mm}$ )

|        |       |
|--------|-------|
| Length | 91mm  |
| Width  | 83mm  |
| Height | 161mm |

#### Weights & Measures

|                       |       |
|-----------------------|-------|
| Mean Weight with Acid | 2.1kg |
| Acid Volume           | 0.5l  |

#### Technology

|            |                               |
|------------|-------------------------------|
| Technology | Cast Sb/Sb                    |
| Separator  | Reinforcing fiber+Glass Fiber |



#### Cell Assembly Layout

#### Terminal Type - 6

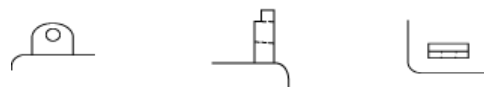
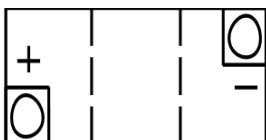

Data Sheet generated on 05/02/2023 - E&OE