



Yuasa Technical Data Sheet

Yuasa 12N11-3B - Conventional 12 Volt Battery

Performance

Voltage	12
Capacity (10-hour)	11Ah
Capacity (20-hour)	11.6Ah
CCA @ -18°C	109A

Dimensions (±2mm)

Length	135mm
Width	90mm
Height	155mm

Weights & Measures

Mean Weight with Acid	3.6kg
Acid Volume	0.8l

Technology

Technology	Cast Sb/Sb
Separator	Reinforcing fiber+Glass Fiber



Cell Assembly Layout

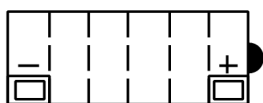

Terminal Type - 6

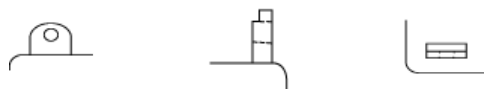

Data Sheet generated on 05/02/2023 - E&OE