



Yuasa Technical Data Sheet

Yuasa 6N12A-2D - Conventional 6 Volt Battery

Performance

| | |
|--------------------|--------|
| Voltage | 6 |
| Capacity (10-hour) | 12Ah |
| Capacity (20-hour) | 12.6Ah |

Dimensions ($\pm 2\text{mm}$)

| | |
|--------|-------|
| Length | 156mm |
| Width | 57mm |
| Height | 116mm |

Weights & Measures

| | |
|-----------------------|-------|
| Mean Weight with Acid | 2.3kg |
| Acid Volume | 0.45l |

Technology

| | |
|------------|-------------------------------|
| Technology | Cast Sb/Sb |
| Separator | Reinforcing fiber+Glass Fiber |



Cell Assembly Layout

Terminal Type - 6

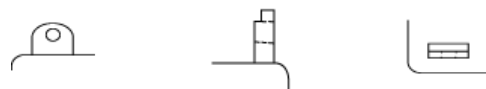
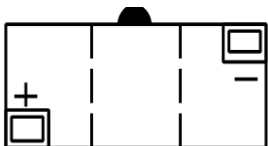

Data Sheet generated on 05/02/2023 - E&OE